

MICROFILMED

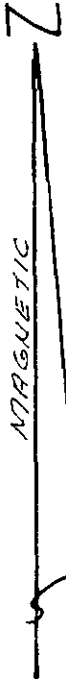

MARTIAN

S 88-48 E 173.48

1.278 AC.

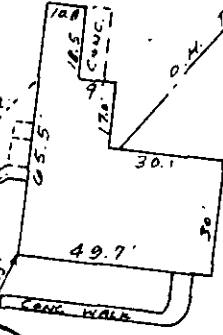
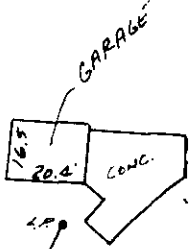

MARTIAN

200'

N 4-27 W

S 20-57 E 45.62

S 20-26 E

ROBERT

MAYN

300.0

ELB.C.

101.93'

N 75-39 W

REF: "SURVEY FOR DRA GREENE KELLEY" BY C.O. RIDDLE NOV. 26, 1983.

TAX MAP: P-25-3-18

TO S.C. HWY 253

N 83-41 W 23.64'

N 63-50 W 87.08'

BELVUE ROAD

N 51-50 W 99.86'

ROAD

SURVEY FOR

R.B. AND EMILY C. SINGLETON

NEAR GREENVILLE, S.C.

SCALE 1" = 50'

APRIL 19, 1985

2 MYO1 85

3.0001

F.B. A-85

I certify that this is an accurate plat of a survey made by me on April 19, 1985, that the structures located on said premises do not encroach or project on adjacent streets or property, that no easements are visible on the ground except as noted hereon, and that the property is not in a designated 100 year flood plain.

FILED GREENVILLE CO. S.C. MAY 1 4 46 PM '85 DONNIE S. JANKERSLEY R.M.C.

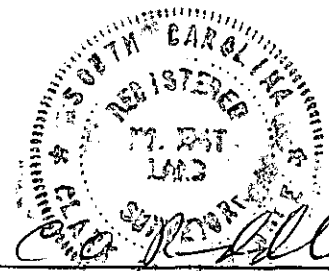

11-M-100

86623

RLS No. 1347 C.O. RIDDLE SURVEYING CO.